



# A DEDICATED COMMUNITY

Pittsburg State University and Southeast Kansas





**Making lives better  
through education**





# Championing Literacy | A Unified Leadership Approach

## PRESIDENT'S OFFICE



**Dr. Dan Shipp**  
President (June 2022)  
*30+ Years in Education*



**Dr. Susan Bon**  
Provost (July 2024)  
*30+ Years in Education*

## COLLEGE OF EDUCATION



**Dr. John Oppliger**  
Interim Dean (July 2024)  
*43+ Years in Education*

## RESEARCH + ECONOMIC DEVELOPMENT



**Dr. Shawn Naccarato**  
Vice President, Research +  
Economic Development  
*17+ Years in Education*

## TEACHING AND LEADERSHIP



**Dr. Jason Clemensen**  
Interim Department Chair -  
Teaching & Leadership (July 2024)  
*20+ Years in Education*

## PSYCHOLOGY AND COUNSELING



**Dr. Robin Blair**  
Department Chair - Psychology  
& Counseling (September 2023)  
*12+ Years in Education*

## CENTER FOR READING



**Dr. David Hurford**  
Executive Director, Center  
for READING  
*40+ Years in Education*





# Impact Data



## USD Locations: 3rd Graders that Scored "Below Basic" 2023 ELA State Assessment

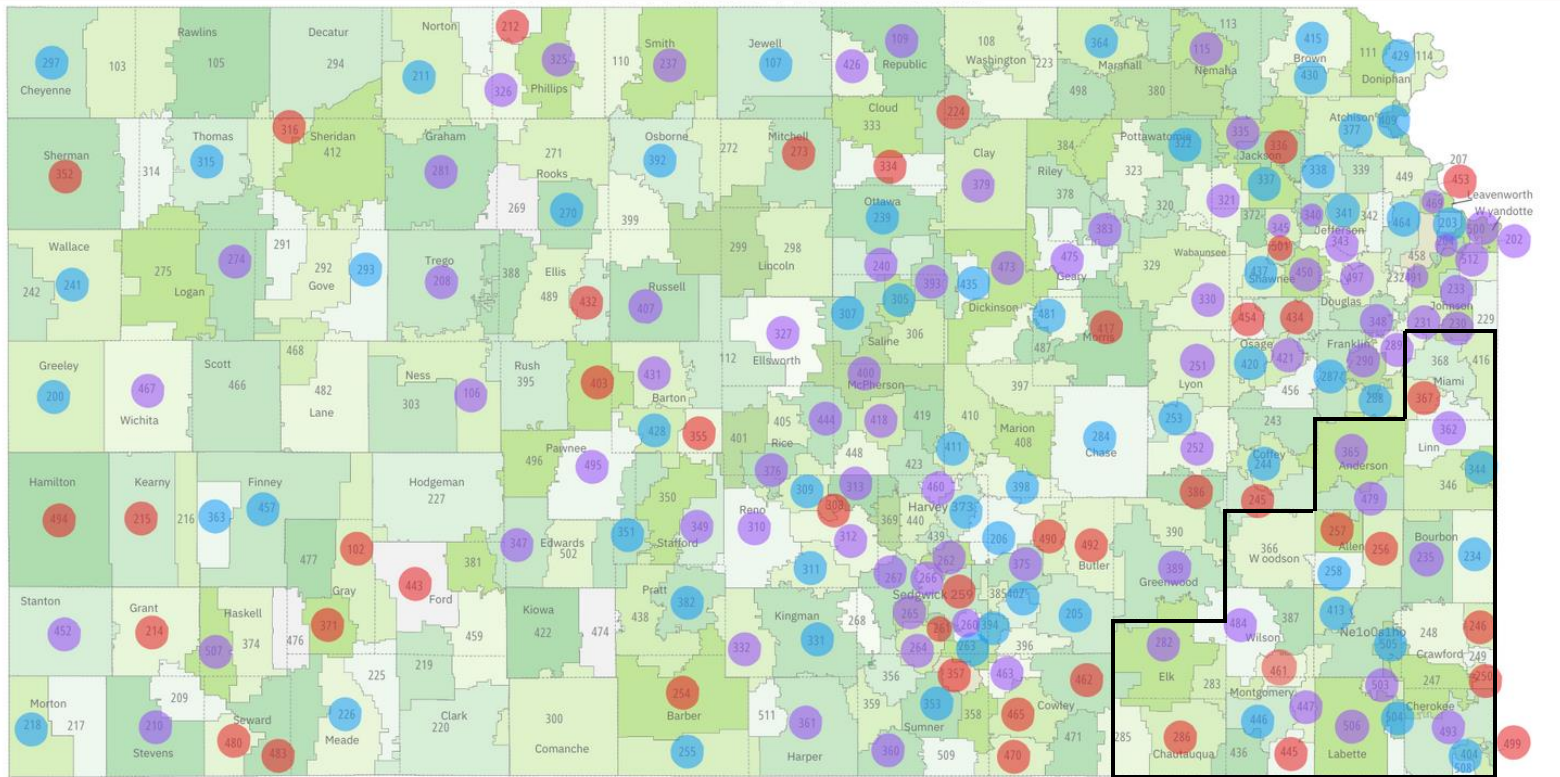

● 40% and higher    ● 30-39%    ● 20-29%

## PSU Catchment Area

■ Community Colleges

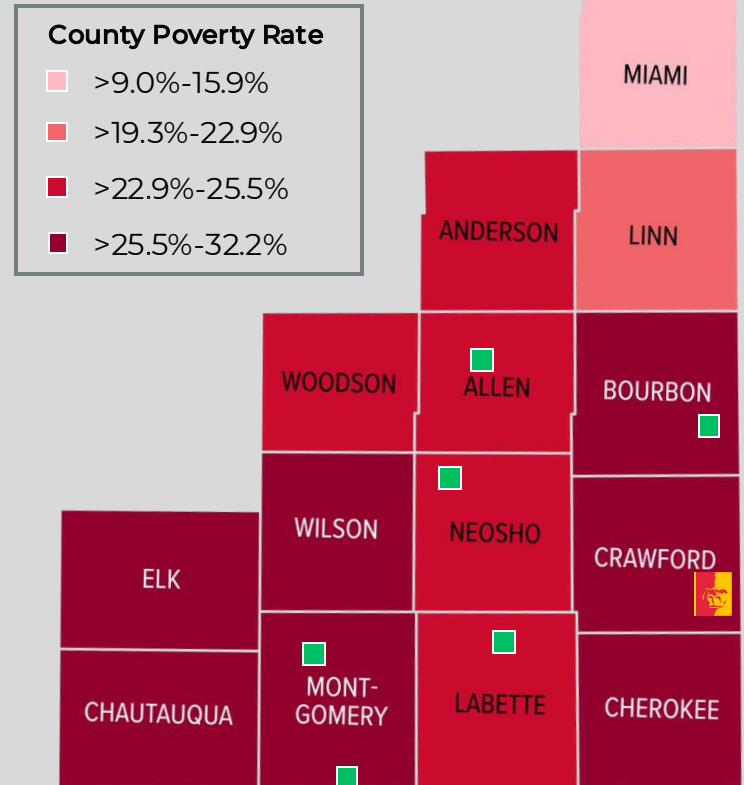

Number of USDs: 40

Number of USD Students: 35,795

Number of Private Schools: 18

Number of Private School Students: 1,980

Total Number of Students: 37,775



# CENTER FOR READING

Opened in 1996

>12,000 Children,  
Adults, and Families

Virtual Services  
Since 2016

Multi-Race/Multi-Language  
“What is Dyslexia?”  
Book for Parents

Screening Tests for  
Dyslexia, ADHD, and Other  
Reading Challenges

In-Person and Virtual  
Interventionist  
Training

# Collaboration Meetings and Listening Sessions

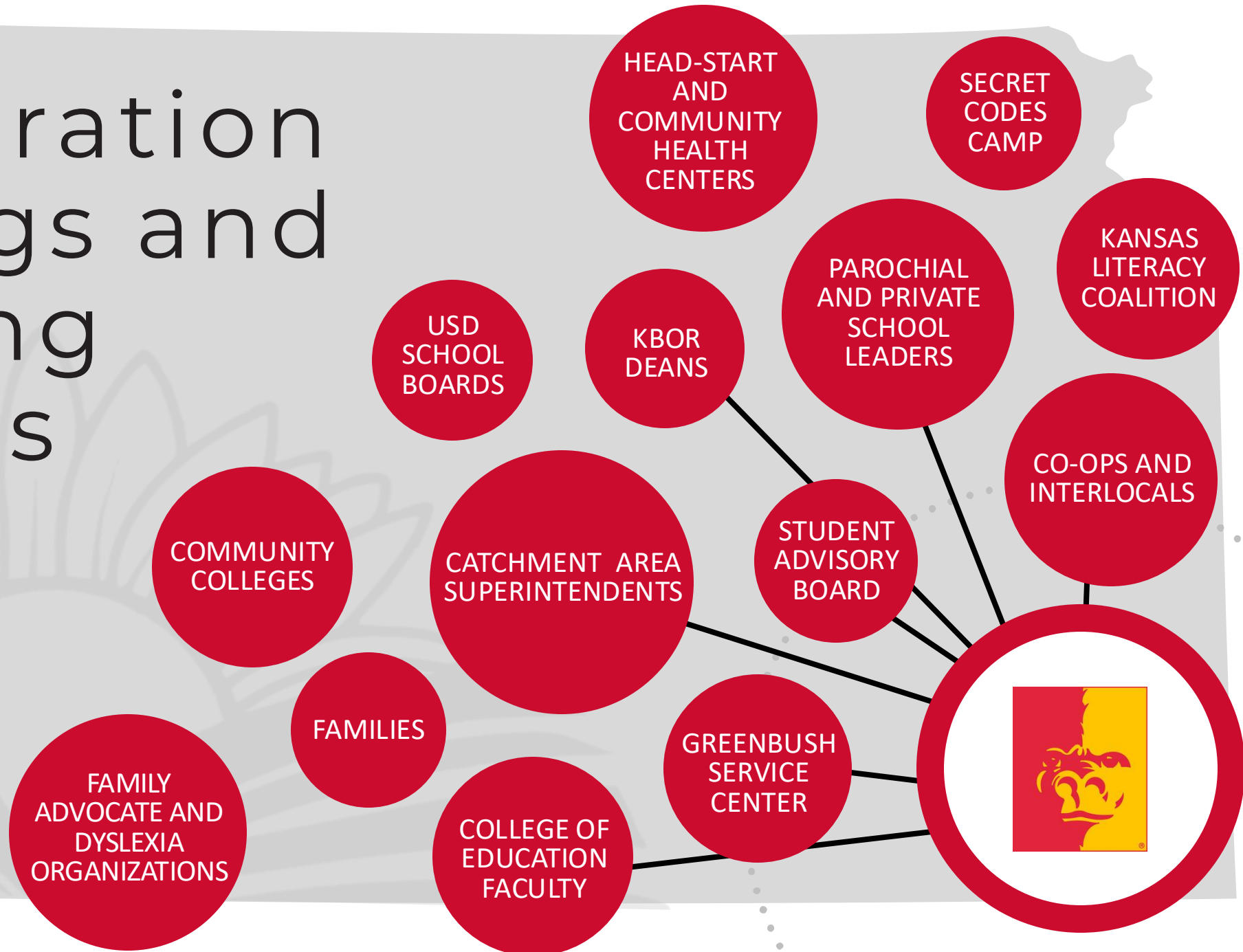



By doing,  
**learn.**





By doing,  
**learn.**





# Education Programs



## Elementary Education

---

### Required Observation and Interaction

- 5 of 8 Semesters
- Starts Freshman Year
- Includes Student Teaching

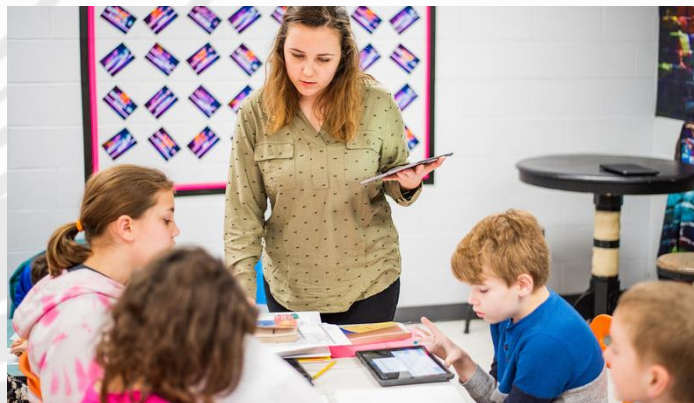

## Elementary Education Unified

---

General Education and Special Education Endorsement

### Required Observation and Interaction

- 6 of 8 Semesters
- PSU was First to Adopt Unified Path in Kansas
- Starts Freshman Year
- Includes Student Teaching



# Program Data

### Elementary Education Reading and ELA Praxis Pass Rate

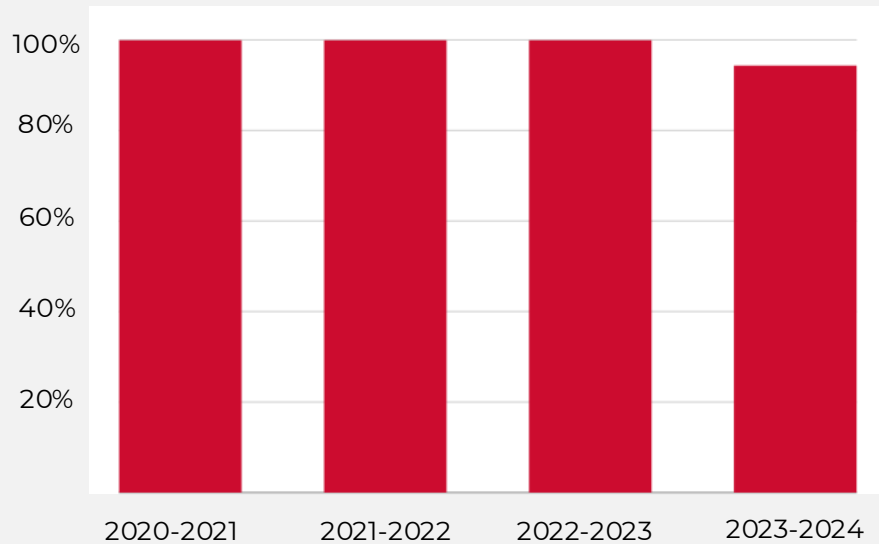

### Elementary Education Total Enrolled

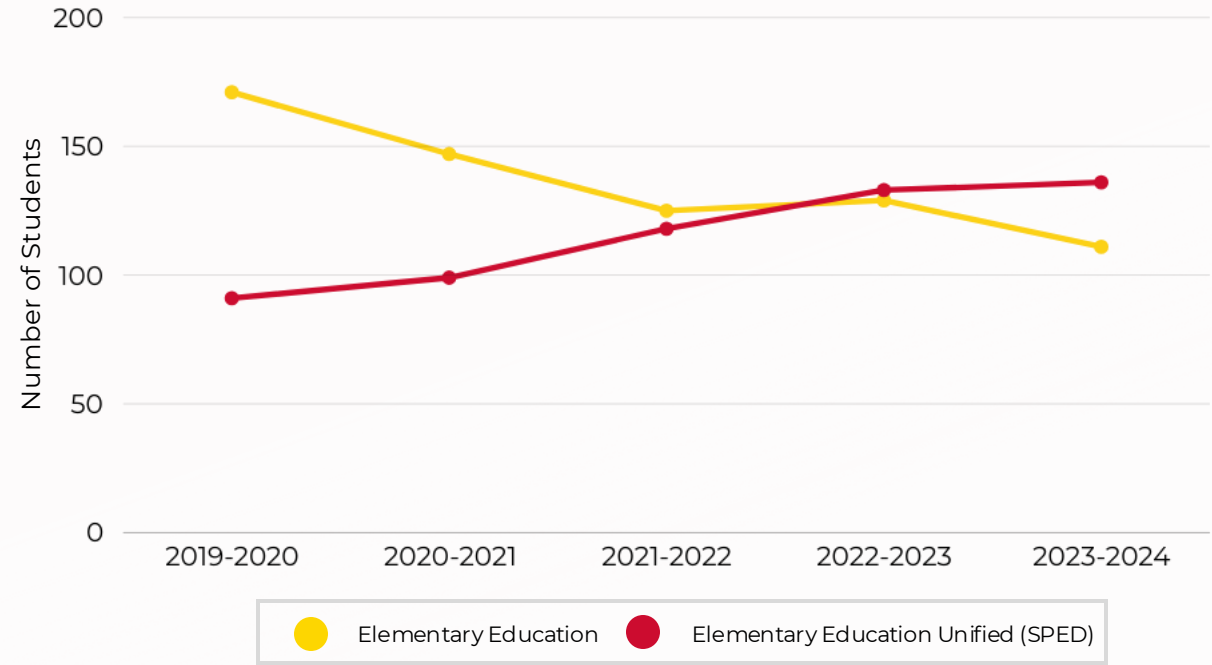

### Elementary Education Graduates

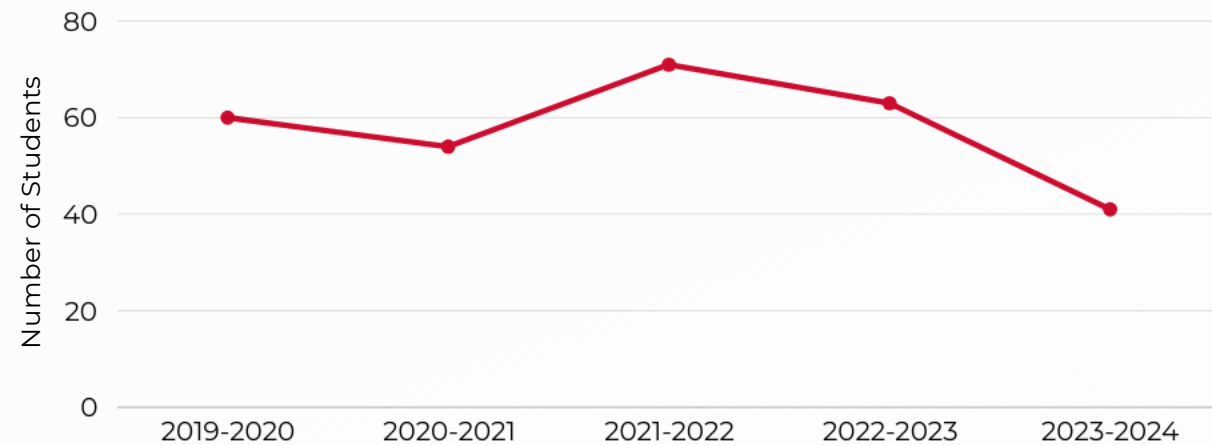





# Striving for Excellence

Mapping of Masters Programs

External Stakeholder Vetting

- EDUC 366 - Science of Reading I
- EDUC 367 - Science of Reading II

Panorama Survey of Current Education Students

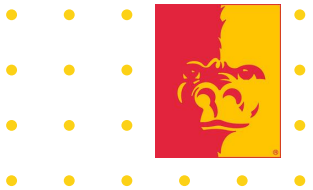



# Simulation Classroom



Video and Audio  
Recording



Tablets Synced to  
Interactive Board



Flexible Seating and Mobile  
Teacher Podium



Interactive Board and  
Magnetic Whiteboards



Triangle Desks and  
Kidney Tables



Document Camera



# 3-Tier Center of Excellence

Screening and Tier 2 and Tier 3 Intervention Services  
Autism Screening  
Community Testing Center  
Lab School Classroom  
Observation Rooms  
Video and Audio Recording Capabilities  
Real-time Coaching  
Pre-service Observation

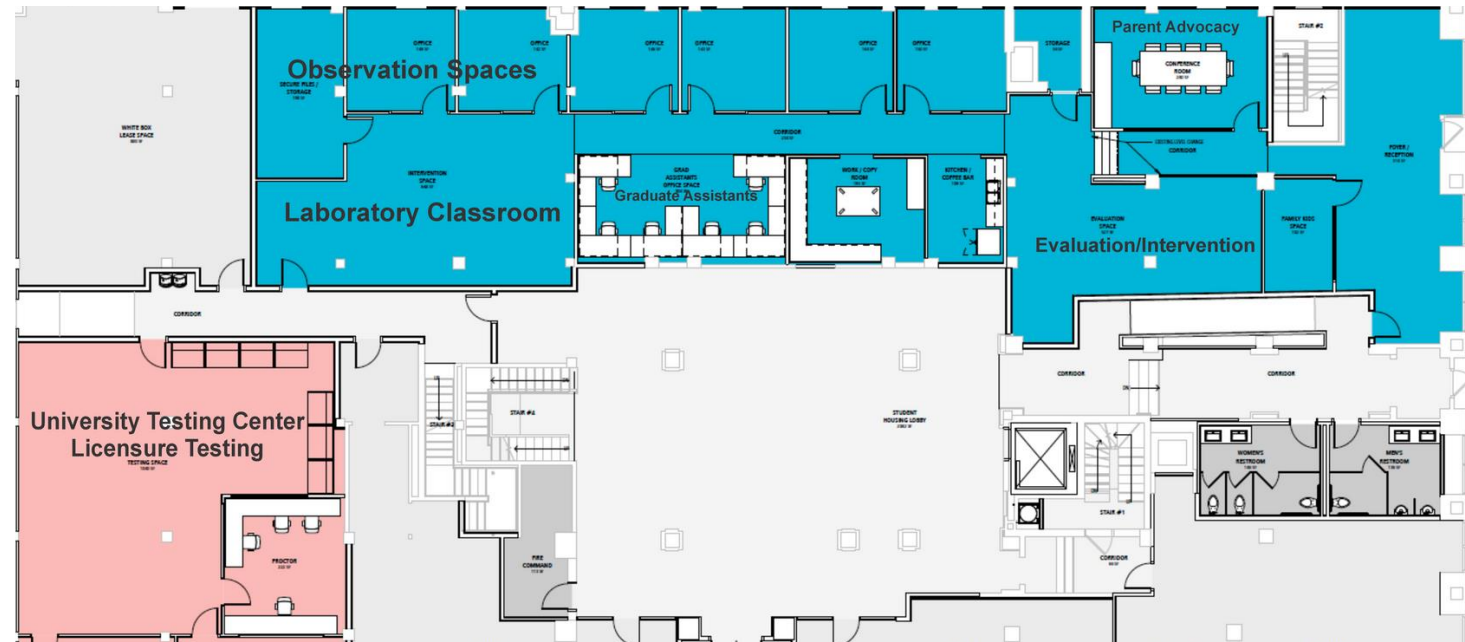
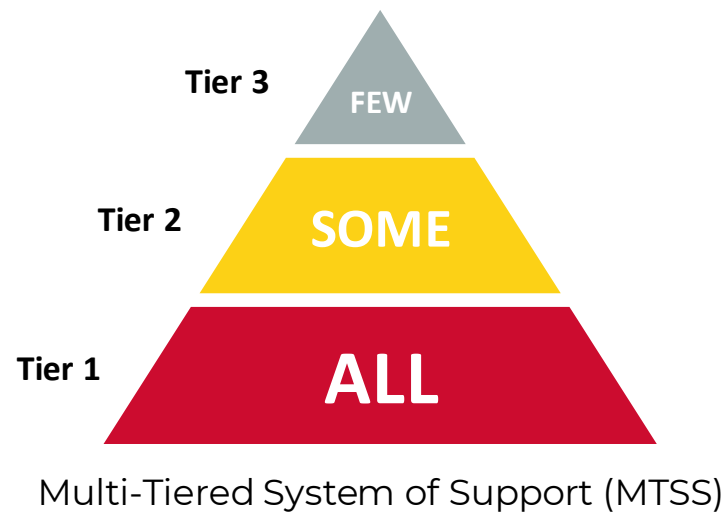

Center for Excellence - 1st Floor Besse Location



# In-Service Coaching

School District On-Site Research Pilots

- Literacy Coaching
- Data Collection
- Intervention Training

Media Library for In-Service Training

Mentoring 2-year Post Graduation Placements



# Overcoming Challenges

Transitioning to New Leadership Team

Strategic Hiring of Two Professors  
with Literacy Expertise

Access to Services for Educators,  
Families, and Students





A photograph of a gorilla statue in a forest, overlaid with a semi-transparent red filter. The statue is the central focus, standing upright with a serious expression. The background shows dense foliage and trees, also tinted with the red overlay.

# Expanding Our Commitment to Literacy

---

Meeting today's challenges to create a  
lasting impact for tomorrow.



